

# solo

## VETERINARY DIAGNOSTICS

POINT-OF-CARE-CENTER

### Test-Panel

- T4
- Fructosamine
- Fibrinogen
- Haemoglobin
- cCRP
- SAA



**EURO**lyser 

- ON THE SPOT, IN HOUSE RESULTS
- RAPID TURNAROUND TIME
- EASY TO USE
- MAINTENANCE FREE
- PORTABLE INSTRUMENT

### EASY TEST PROCEDURE

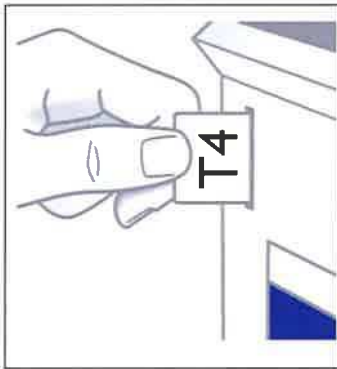

- insert RFID card

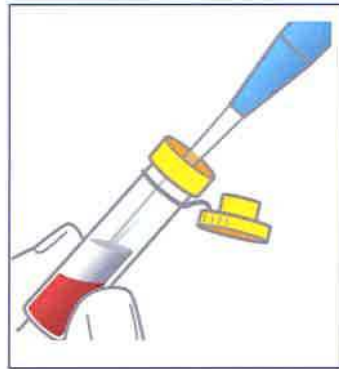

- collect sample

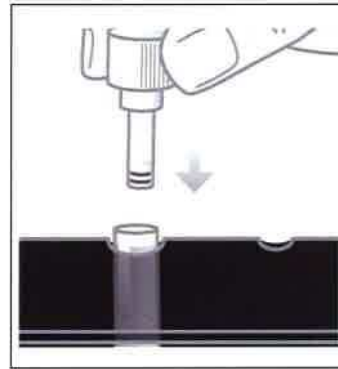

- add sample
- apply ERS (Eurolyser-Reagent-System) cap

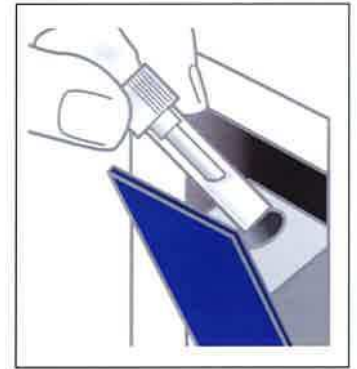

- insert ERS into smart analyser
- touch display to start - done!

parameter	sample material (volume)	assay range	precision within run
T4	serum/li-hep plasma (20 µl)	0 - 40 µg/dl [0 - 515 nmol/l]	cv < 5,0% (at 4 µg/dl)
Fructosamine	serum/li-hep plasma (20 µl)	0 - 2000 µmol/l [0 - 2 mmol/l]	cv < 3,0% (at 565 µmol/l)
Fibrinogen	EDTA or citrate plasma (20 µl)	50 - 1250 mg/dl [0,5 - 12,50 g/l]	cv < 3,0% (at 338 mg/dl)
Haemoglobin	whole blood (20 µl)	0,5 - 30 g/dl [0,3 - 18,6 mmol/l]	cv < 2,5% (at 14 g/dl)
cCRP	serum/li-hep plasma (50 µl)	5 - 240 mg/l [0,5 - 24 mg/dl]	cv < 5,0% (at 30 mg/l)
SAA	serum/li-hep plasma (5 µl)	10 - 500 µg/ml [10 - 500 mg/l]	cv < 8,0% (at 99 µg/ml)

### INSTRUMENT SPECIFICATION

- maintenance free analyser
- size 26 x 14.5 x 14 cm
- weight 3.5 kgs (7.7 lbs)
- 100-240V (50-60 Hz)
- CE
- computer/host interface (RS 232 or USB)
- optional: printer, barcode reader

Technical details subject to change without notice

Your local solo Partner:



Eurolyser Diagnostica GmbH Tel. +43(0)662/432100  
 Bayernstraße 11a Fax +43(0)662/432100-50  
 5020 Salzburg/Austria www.eurolyser.com